

# SERIES 16-3

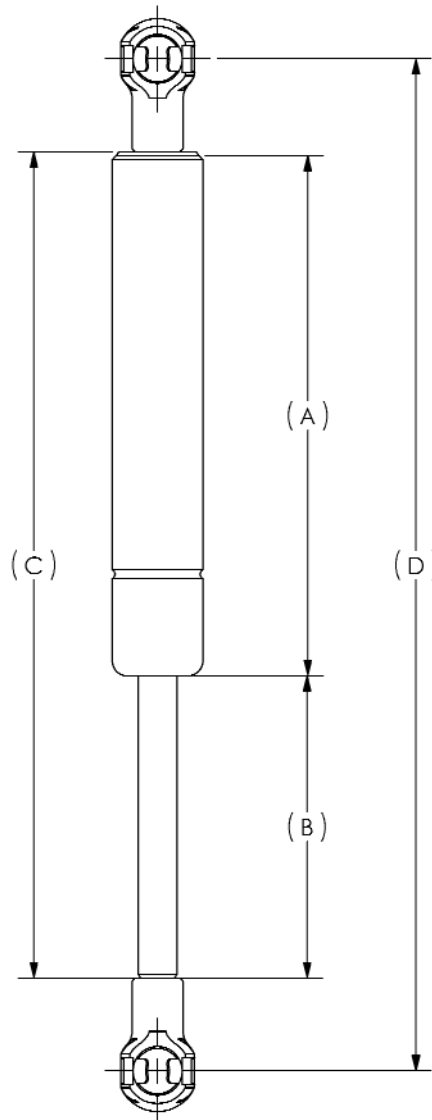

Tube Lengths	
Min.	Max.
85	535



Tube bodies are treated with a highly corrosion-resistant coating. The piston rods are induction-hardened prior to receiving a durable, black nitride surface.

Each SUSPA gas spring is manufactured with a specific quantity of oil, which serves both as a lubricant and damping medium. Relatively higher oil quantities increase damping and also increase the extended-to-compressed force ratio.

## 16-3

Minimum force (P<sub>1</sub>)      Maximum force (P<sub>1</sub>)  
100N      600N

**Order Example**  
**16-3-271-200-A285-B144-400N**  
(A)      (B)      (end fittings)      (P<sub>1</sub>)

Minimum tube length  
(A) = rod (B) + 37

### ALL DIMENSIONS IN MILLIMETERS

INDEX: One inch = 25.4 millimeters

One pound = 4.448 Newtons

○ = Available Combinations

● = Most Commonly Used

Minimum and maximum forces are expressed in the extended position (P<sub>1</sub>).

Maximum compressed forces will exceed extended forces by 30% to 80%, depending on internal oil quantity.

Tube Diameter	22mm
Rod Diameter	8mm
Thread Tube End	M8 x 1.25mm
Thread Rod End	M6 x 1.0mm