

SERIES 16-2



Tube bodies are treated with a highly corrosion-resistant coating. The piston rods are induction-hardened prior to receiving a durable, black nitride surface.

Each SUSPA gas spring is manufactured with a specific quantity of oil, which serves both as a lubricant and damping medium. Relatively higher oil quantities increase damping and also increase the extended-to-compressed force ratio.

Tube Lengths

Min.	Max.
85	340

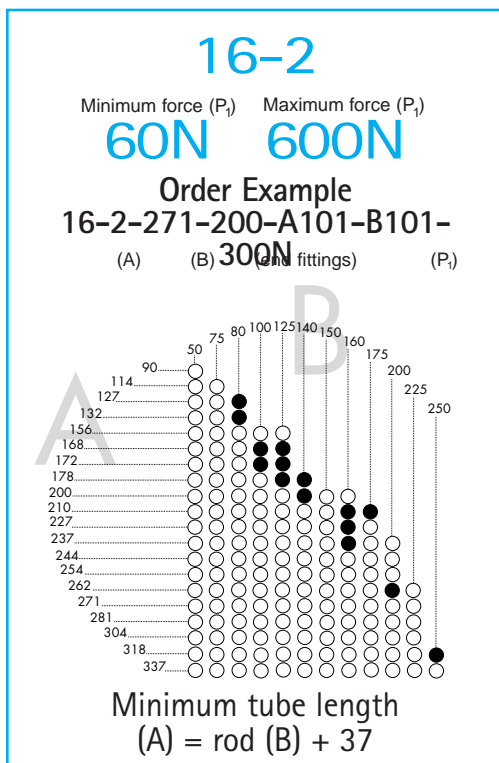

ALL DIMENSIONS IN MILLIMETERS

INDEX: One inch = 25.4 millimeters

One pound = 4.448 Newtons

○ = Available Combinations

● = Most Commonly Used

Minimum and maximum forces are expressed in the extended position (P₁).

Maximum compressed forces will exceed extended forces by 30% to 80%, depending on internal oil quantity.

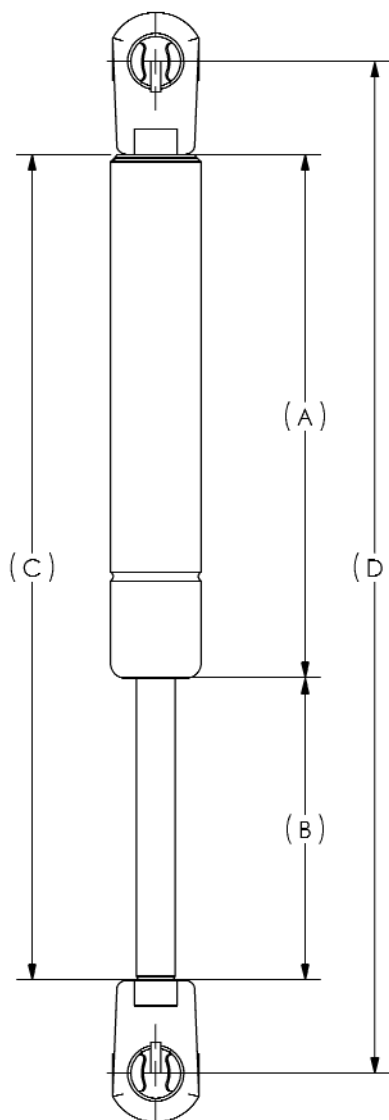

Tube Diameter	19mm
Rod Diameter	8mm
Thread Tube End	M6 x 1.0mm
Thread Rod End	M6 x 1.0mm